

MU 800/900/1800/2100/2600-LX

Multi-frequency Mobile Antenna for the 800 MHz, 900 MHz, 1800 MHz, 2100 MHz and 2600 MHz Bands

DESCRIPTION

- Multi-frequency antenna – multi bands – one antenna!
- Stainless steel LX-mount.
- Especially suited for roof mounting.
- Provided with FME-connection (supplied without cable).
- Flexible section in mount for adjustment of whip (tiltable 15° by hand).
- Installation with access from the outside only (requiring an 18 mm dia. hole).

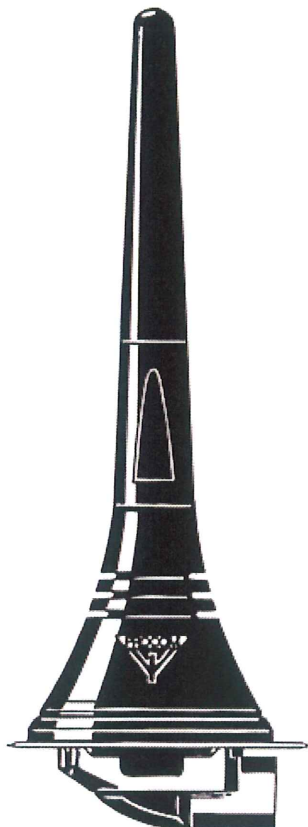

ORDERING DESIGNATIONS

TYPE	PRODUCT NO.
MU 800/900/1800/2100/2600-LX	130001567

SPECIFICATIONS

ELECTRICAL	
MODEL	MU 800/900/1800/2100/2600-LX
ANTENNA TYPE	Multi-frequency mobile antenna
FREQUENCY	790 - 862 MHz 880 - 960 MHz (EGSM/NMT-900) 1710 - 1880 MHz (DCS-1800/PCN) 1900 - 2200 MHz (UMTS) and 2500 - 2690 MHz
IMPEDANCE	Nom. 50 Ω
POLARIZATION	Vertical
GAIN	Approx. 0 dB on all bands (acc. to EIA RS-329-1)
BANDWIDTH	800 MHz: > 50 MHz @ SWR \leq 2.0 900 MHz: > 40 MHz @ SWR \leq 1.5 1800 MHz: Approx. 200 MHz @ SWR \leq 2.0 (typ.) 1900 - 2200 MHz @ SWR \leq 2.0 (typ.) and 2600 MHz: > 200 MHz @ SWR \leq 2.5 (typ.)
SWR	\leq 2.5
MAX. POWER	15 W
MECHANICAL	
MATERIALS	Whip: Black cover POM Black-chromed brass Mount: Stainless steel Brass Weather- and shockproof plastics
RECOMMENDED INSTALLATION TORQUE	3.5 Nm max.
CABLE	FME-cable to be ordered separately
COLOUR	Black
HEIGHT	93 mm
WEIGHT	Approx. 33 g
MOUNTING	18 mm dia. hole

INSTALLATION

The LX-mount is especially suited for roof-mounting. It is recommended to mount the antenna at the centre of the roof to ensure the best omnidirectional coverage. Mounting can take place in an 18 mm dia. hole with access from the outside only. When cleaning the car in car-washing machines, the whip should be removed – a 9 mm fork spanner can be used. After wash, the whip is refitted and tightened lightly with the spanner. The mount is equipped with a bendable section ($\pm 15^\circ$) to make it possible to adjust the antenna to an upright position.

1. INSTALLATION DIMENSIONS:

LX-MOUNT

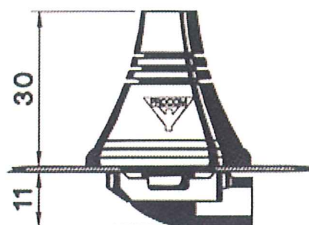
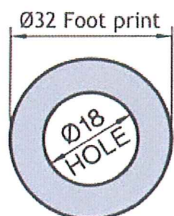

2. INSTALLATION STEPS:

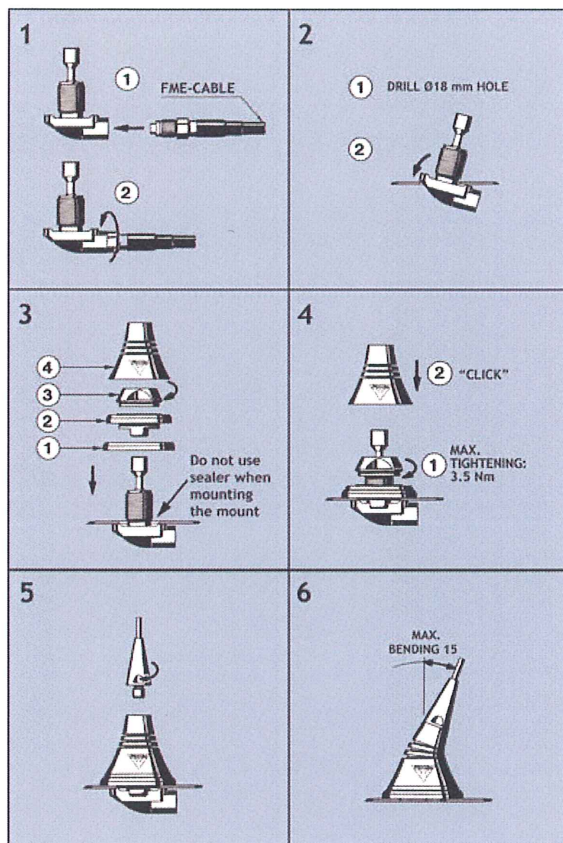

Do not use sealer on rubber gasket or other places.

PLEASE NOTE: When tightening the revolving nut (see picture 4), special care must be taken to keep the spanner in the correct position.

3. TUNING:

The antenna is delivered factory-tuned and requires no further tuning

PROCOM A/S reserve the right to amend specifications without prior notice.

12/12/12